



Your Solutions Partner

Installation Manual

Bread Laminate Kits:

FORM BWLAM END BREAD FS

FORM BWLAM END BREAD ADA FS

Parts In Kit

One (1) Piece of Laminate

One (1) Bottom Trim Piece

Two (2) Side Trim Pieces

Four (4) Screw, 10-24 X 3/8" PTHMS

Three (3) Screw #10 X 1/2" HWH TEK

One (1) #21 Drill Bit

Tools Needed

Phillips Screwdriver

Cordless Drill

5/16" Wrench

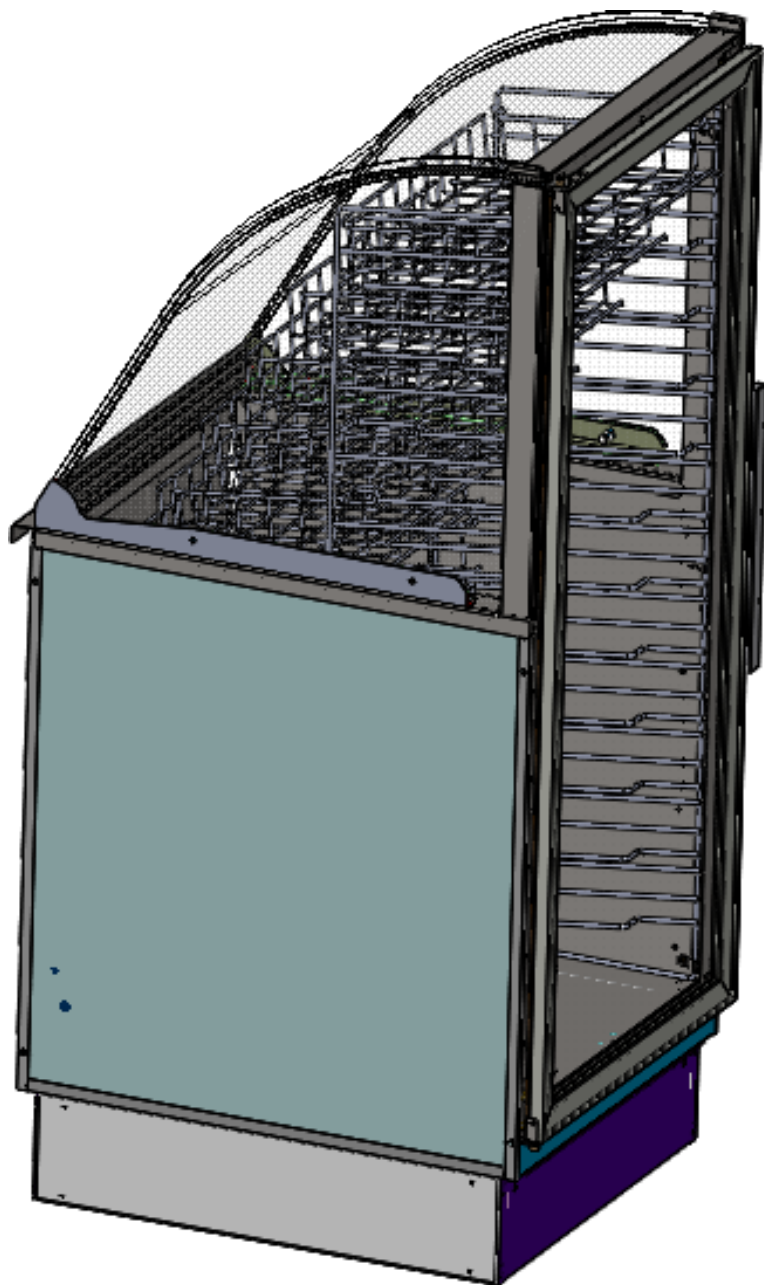

CAUTION: Please read this manual completely before attempting to install, operate or service this equipment

ASSEMBLY

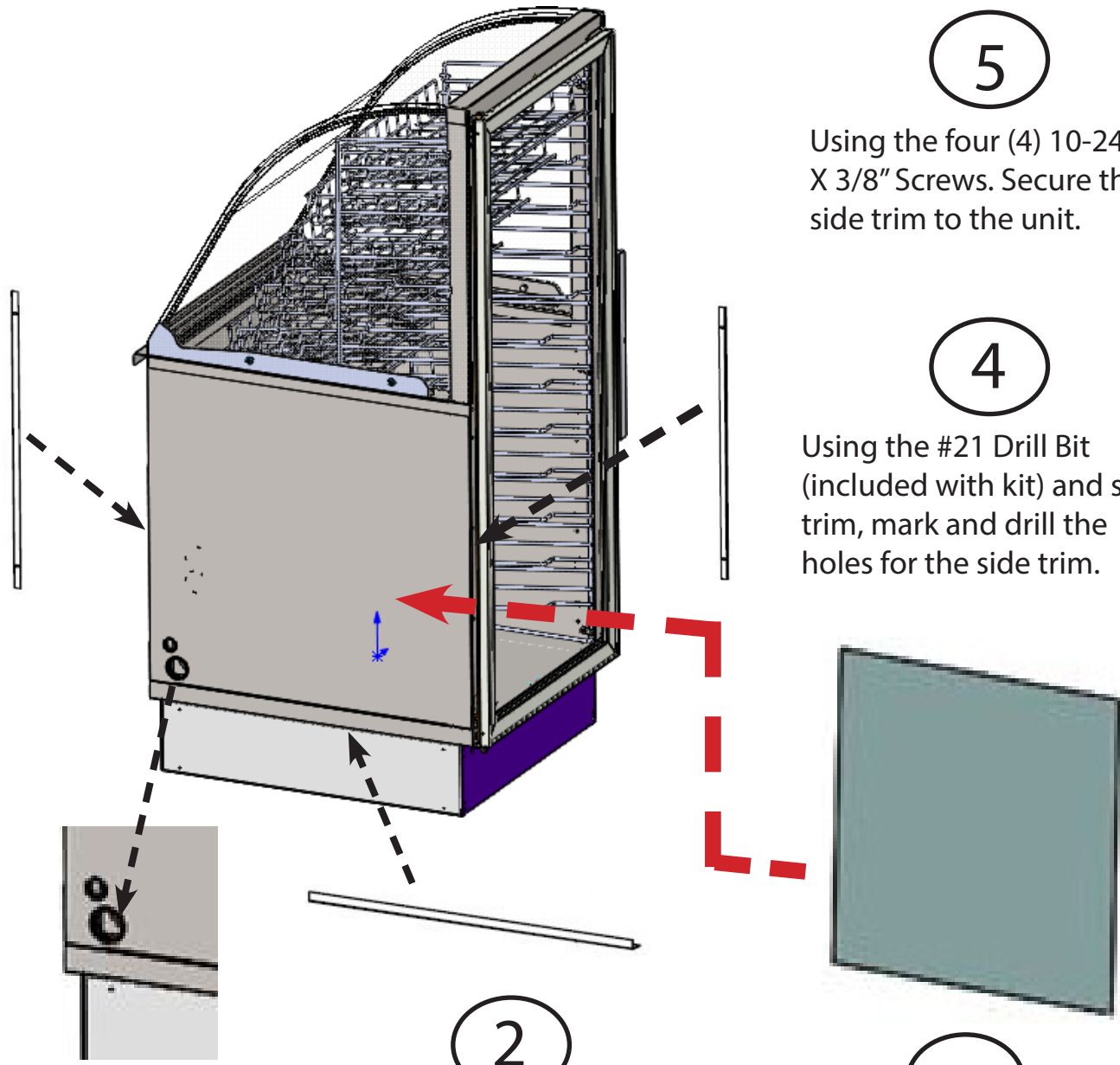

1

Remove Gromets

Using the three (3) #10 X 1/2" TEK Screws, Secure the bottom trim to unit.

NOTE: Holes located on underside of unit.

2

3

Slide Laminate Panel in from back of unit.

5

Using the four (4) 10-24 X 3/8" Screws. Secure the side trim to the unit.

4

Using the #21 Drill Bit (included with kit) and side trim, mark and drill the holes for the side trim.



Your Solutions Partner

Duke Manufacturing Co.

2305 N. Broadway
St. Louis, MO 63102

Phone: 314-231-1130
Toll Free: 1-800-735-3853
Fax: 314-231-5074

www.dukemfg.com